

\$624,800 - 26413 Twp Rd 540, Rural Sturgeon County

MLS® #E4428414

\$624,800

0 Bedroom, 0.00 Bathroom,
Rural on 85.67 Acres

None, Rural Sturgeon County, AB

SMALL FARM OPPORTUNITY - Ideally located at the **TOP OF THE HILL** just **10 MIN FROM ST.ALBERT**, Edmonton or Spruce Grove. **BUILD YOUR DREAM HOME** with views to the South, add a Barn, Shop, **SECOND RESIDENCE**, all are permitted under the zoning. Power and Gas at the road and **LESS THAN 1KM OF GRAVEL**. Great opportunity to get into the country and still be close to town. **BUSSING TO SCHOOL IN ST.ALBERT K-9**, **86 ACRES OF HIGH PRODUCING SOIL**, seeded to pasture and hay and suitable for grains. Cross fenced and **SET UP FOR HORSES** with multiple ponds.

Essential Information

MLS® #	E4428414
Price	\$624,800
Bathrooms	0.00
Acres	85.67
Type	Rural
Sub-Type	Vacant Lot/Land
Status	Active

Community Information

Address	26413 Twp Rd 540
Area	Rural Sturgeon County
Subdivision	None

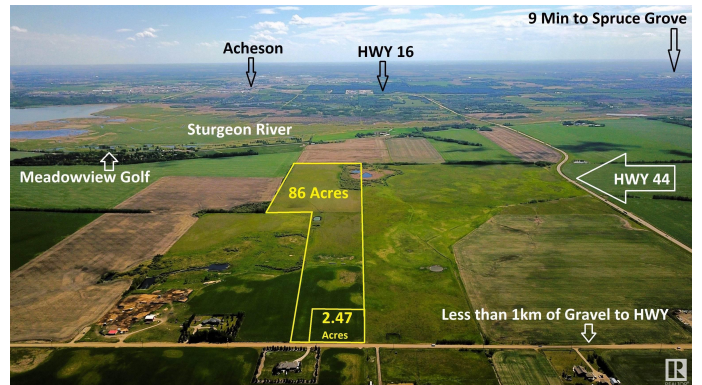

City	Rural Sturgeon County
County	ALBERTA
Province	AB
Postal Code	T8T 1K6

Exterior

Exterior Features Airport Nearby, Cross Fenced, Golf Nearby, Rolling Land, See Remarks

Additional Information

Date Listed April 1st, 2025

Days on Market 2

Zoning Zone 70

DATA IS DEEMED RELIABLE BUT IS NOT GUARANTEED ACCURATE BY THE REALTORS® ASSOCIATION OF EDMONTON. COPYRIGHT 2025 BY THE REALTORS® ASSOCIATION OF EDMONTON. ALL RIGHTS RESERVED. Trademarks are owned or controlled by the Canadian Real Estate Association (CREA) and identify real estate professionals who are members of CREA (REALTOR®, REALTORS®) and/or the quality of services they provide (MLS®, Multiple Listing Service®)

Listing information last updated on April 3rd, 2025 at 3:47pm MDT